

Mini DMX Controller



Device description

PX333 controller was designed for applications requiring a dynamic decorative light control, such as salons SPA, saunas and multirooms. It also perfectly fulfill its function as a controller for illumination of small architecture, interior or private apartments.

For communication with the environment it uses 8 *On/Off* inputs (to which can be connected, for example buttons, motion detectors or twilight switches) and LAN interface. This allows the PX333 controller to be connected to computer network and thereby control the device using the Android™ smartphone. It is also possible to control it from PC. The PXM company provides the PxMini application to operate the device on PCs with Windows® or Linux operating systems.

PX333 sends 64 DMX-512 channels and has 3 OC outputs with a load capacity of 1500mA each, allowing for direct control of LEDs. DMX output channels can be divided into 16 zones controlled independently.

The device is designed to control both rapid and slow changes in lightning; it is also suitable for controlling intelligent devices. PX333 memory allows storing 32 scenes and 8 programs.

The Mini DMX Controller comes with implemented support for the Modbus protocol which allows to control the controller using external devices.

Technical drawing

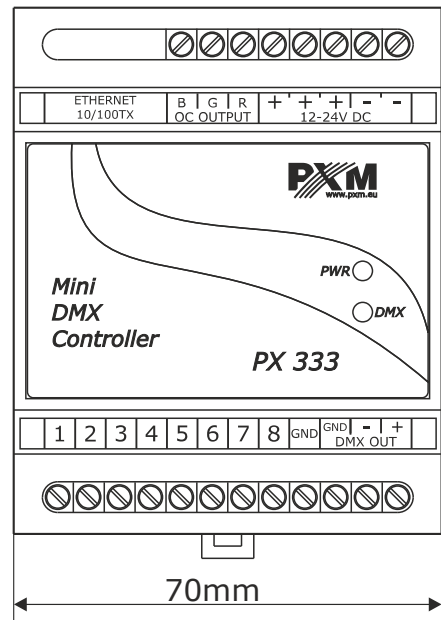
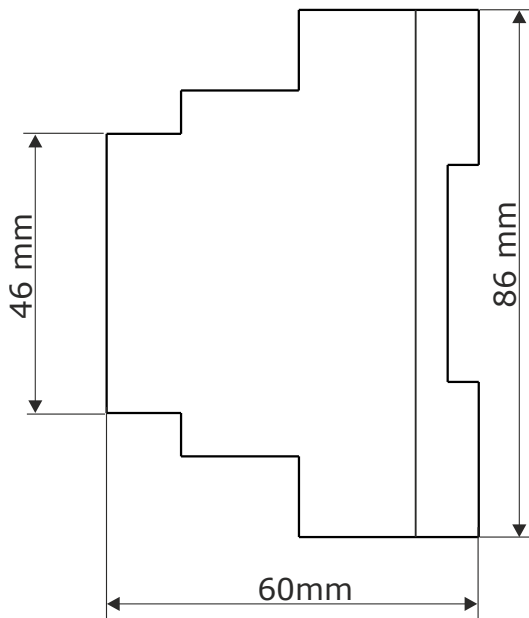

Connection diagram

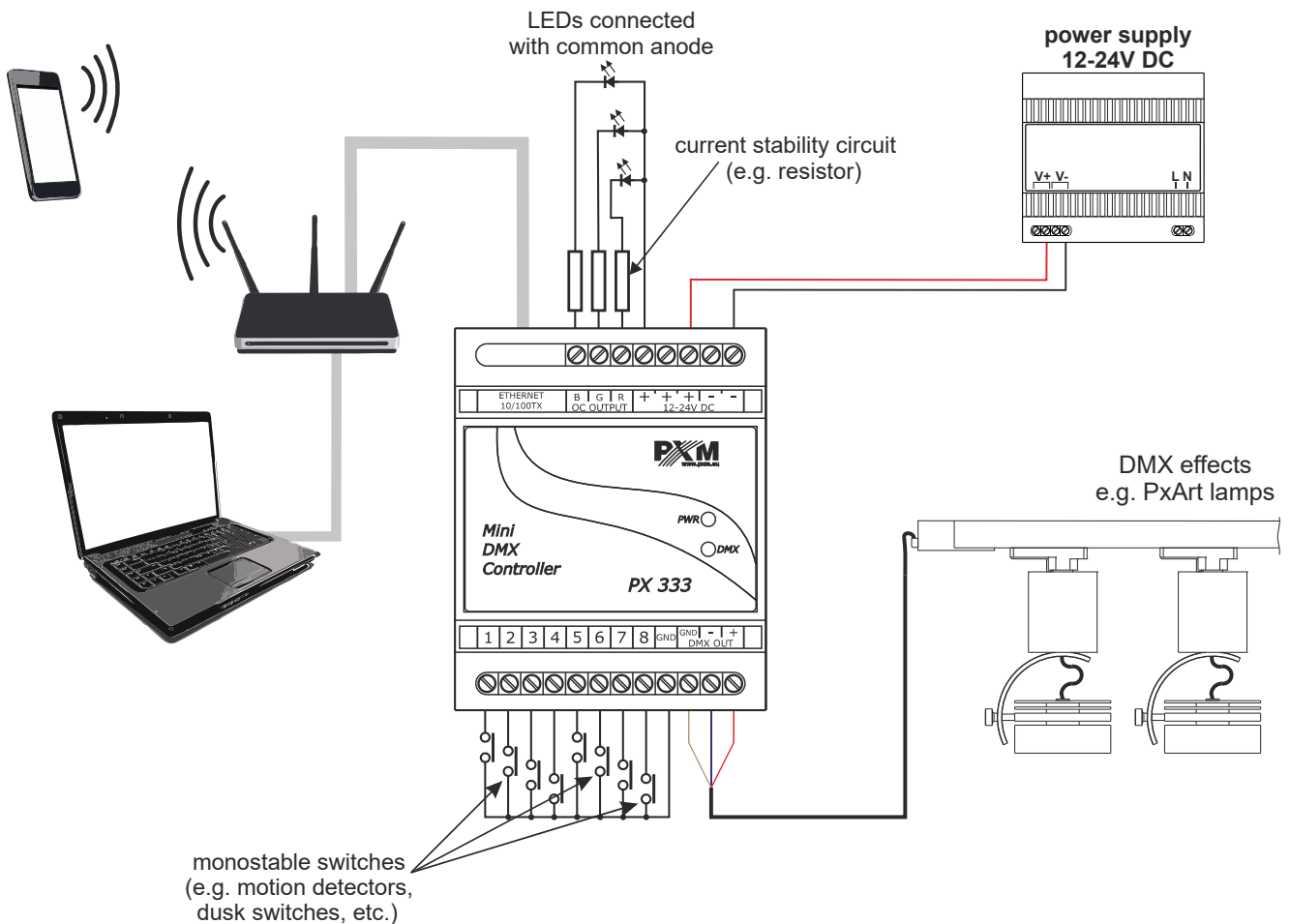

Technical data

type	PX333
power supply	12 – 24V DC
no-load current consumption	70mA for 12V DC 40mA for 24V DC
DMX output channels	64
control inputs On/Off	8
control outputs OC	3
OC outputs load capacity	1500mA / channel
communication	LAN
controller memory	scenes: 32 programs: 8 zones: 16 element lists: 16
range of scene / steps time	0,1s – 24h
weight	0.1kg
dimensions	width: 70mm (4 DIN rail modules) height: 86mm depth: 60mm