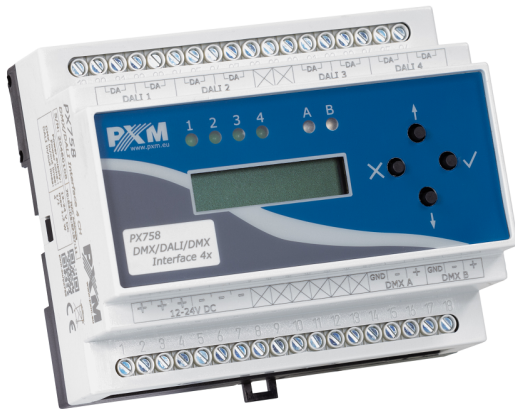

DMX / DALI / DMX
Interface 4x

Device description

DMX / DALI / DMX Interface 4x is an advanced converter that allows to connect lighting installations based on the DALI protocol with DMX control systems. Using the PX758, you can connect to the controller sending the DMX signal receiving devices working in the DALI protocol. The PX758 module also allows you to convert the signal from DALI input devices (sensors / buttons) into a DMX signal.

According to the DALI standard, one line can be connected to max. 64 receiving devices (ballasts) and 64 input devices. The PX758 module is equipped with one DMX input line, one DMX output line and four DALI lines, which allow you to connect a total of up to 256 ballasts and 256 input devices.

Managing the PX758 settings is possible using the buttons and the screen on the casing or using the Web Server built into the device. Changing the settings includes:

- searching and addressing DALI devices,
- changing parameters of input devices,
- change of ballast parameters (e.g.: brightness, address, "fade time", "fade rate", etc.),
- configuration of the conversion of the DMX signal to DALI ballasts and the signal from the DALI input devices to the DMX signal,
- changing the module network settings,
- software update.

DMX / DALI / DMX Interface 4x has been placed in a housing adapted for mounting on a 35mm DIN rail and is supplied with 12 – 24V DC safe voltage. Please note that the DALI line must have external power supply.

Technical drawing

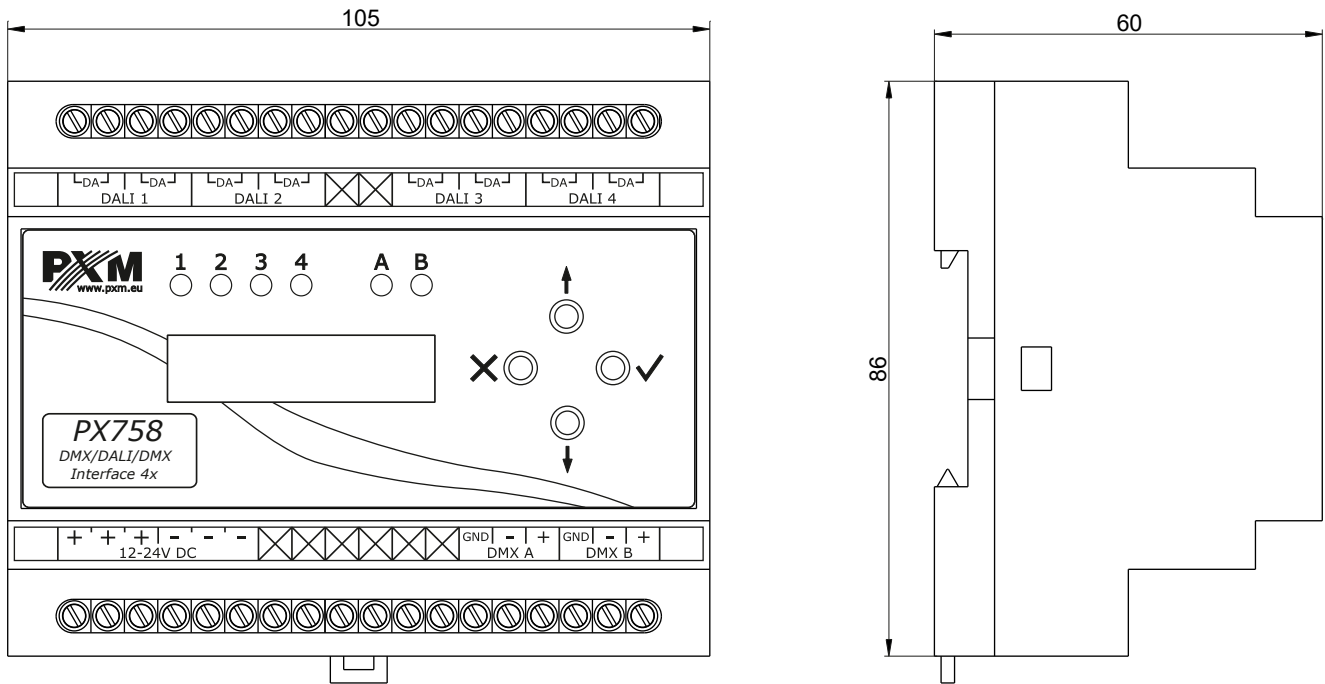

Connection diagram

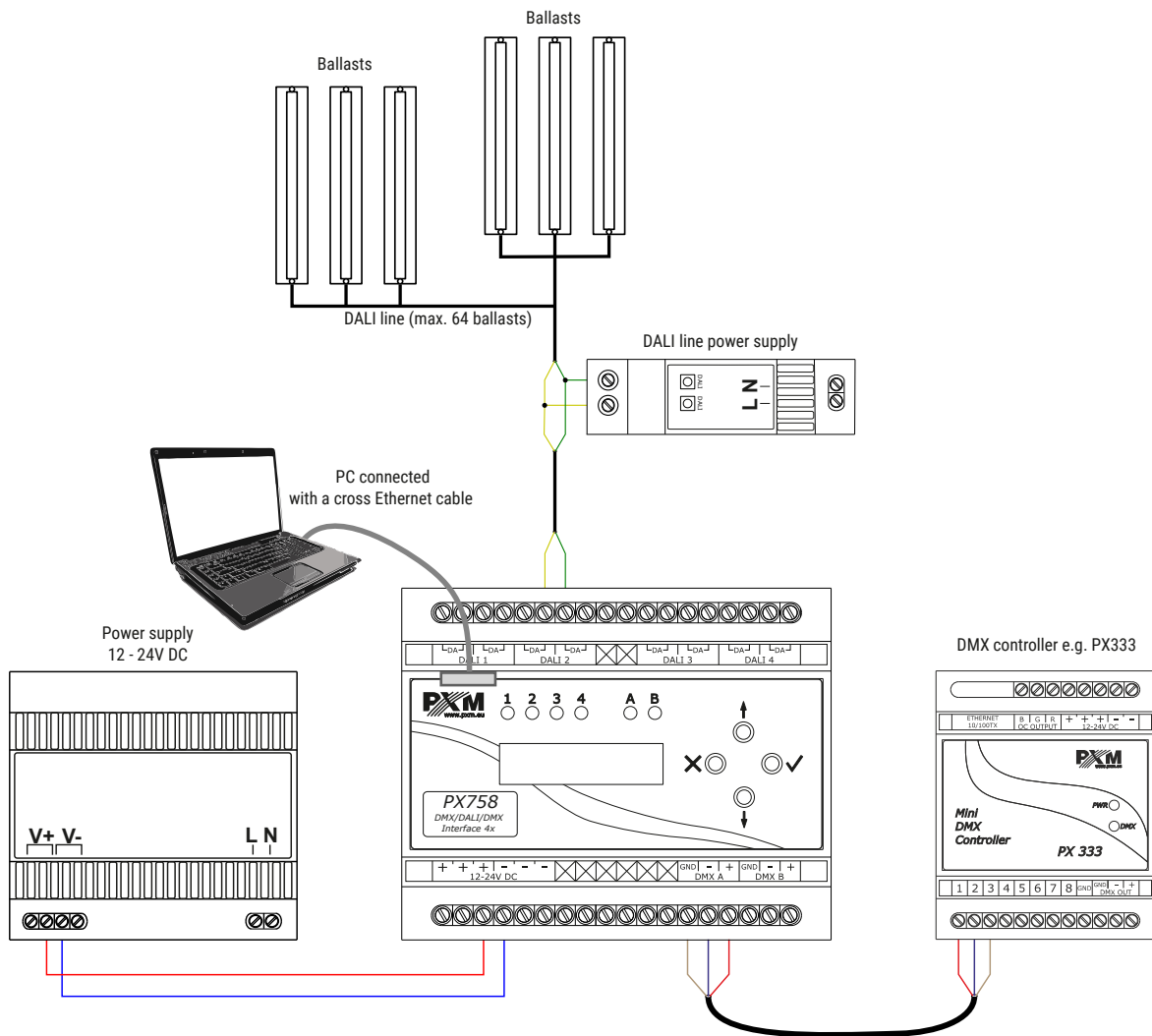

Example of PX758 operation with a motion / light / presence sensor working in the DALI system and with a DMX controller:

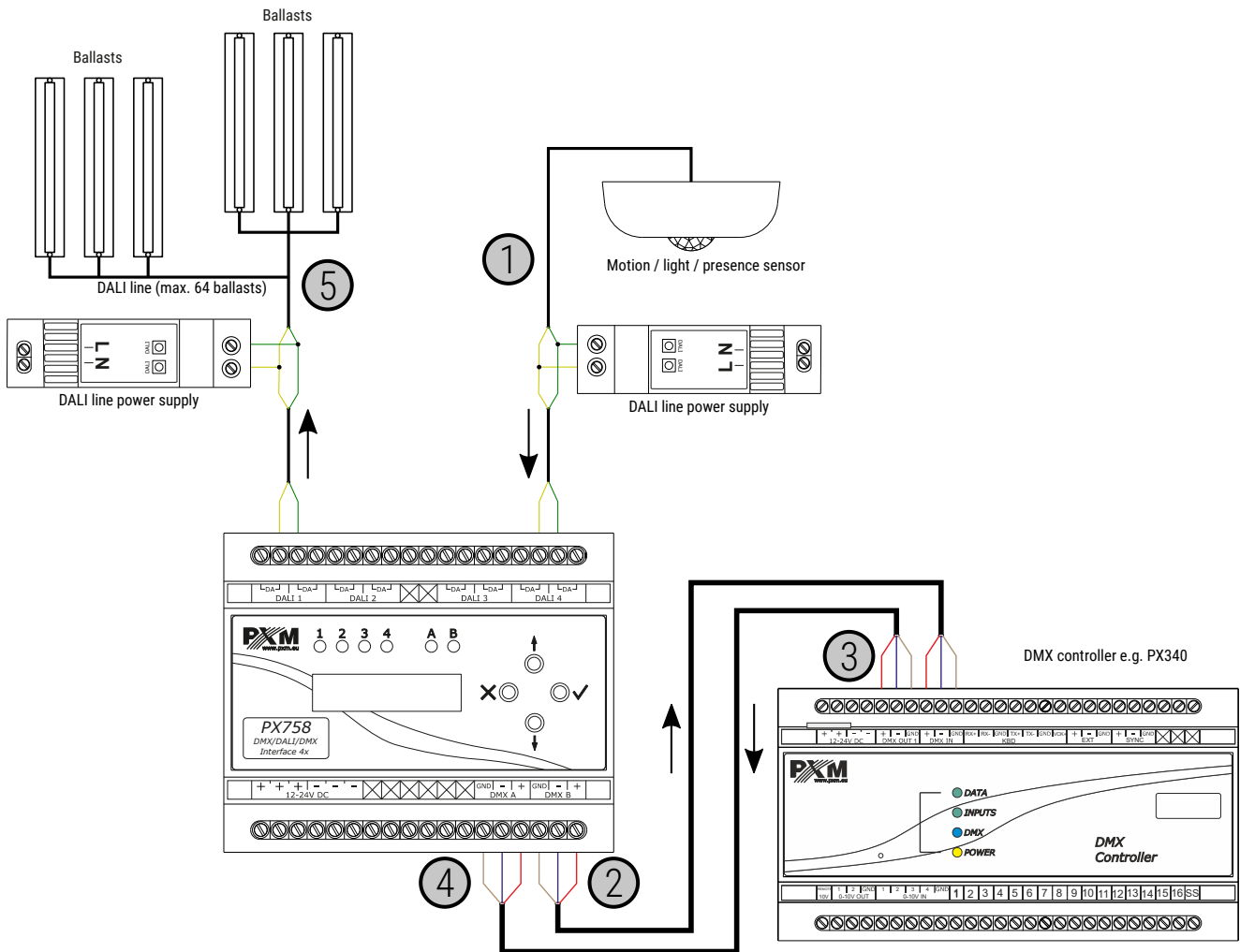

1. The motion / light / presence sensor works on the DALI line and sends a signal to the PX758.
2. The DMX / DALI / DMX Interface 4x signal converter converts the signal from the **DALI 4** input into a DMX signal and sends it to the **DMX B** output.
3. The controller (e.g. PX340) receives the DMX input signal (**DMX IN**), performs the actions that were previously configured in PxDesigner and sends a new DMX signal (**DMX OUT**) to the PX758 or other DMX signal receiver.
4. PX758 receives the DMX signal at the **DMX A** input and converts it into a DALI signal.
5. The converted signal from DMX to DALI is sent to the **DALI 1** line (ballast control).

NOTE! The above configuration is only an example and is intended to illustrate the operation of the device. The sensor can be connected to any DALI line, additionally it can be connected to a line where ballasts are also connected – then the PX758 should be properly configured.

Technical data

type	PX758
power supply	12 – 24V DC
DMX input / output	1 / 1
DALI ports	4
Ethernet ports	1
DMX channels	512 / 512
number of supported DALI IN / OUT devices	256 / 256 (64 inputs + 64 outputs for one line)
supported ballasts	DT0 – DT8
control characteristics	DALI / linear
DALI line test	from the LCD
programming	LCD display 2 x 16 and 4 buttons Web Server
version of the DALI protocol	2.0
weight	0.2kg
dimensions	width: 105mm height: 86mm depth: 60mm