



Device description

The PX340+ DMX Controller is an advanced architectural lighting controller that allows for controlling even the most complex lighting systems. With programmable functions, the device enables the control of lighting, multimedia, and other devices that are operated based on the DMX protocol.

The controller has 1 DMX output line (512 channels), 1 DMX input line, and it allows for triggering multiple configuration items at the same time. Events can be triggered by an astronomical clock, a real time clock, programmed timers, analogue or digital inputs, mobile device applications or via the Modbus protocol.

An advanced PC application PxDesigner (Windows®) allows for programming the device. The application has a built-in library of devices that can be distributed on a graphic project, which facilitates the creation of complex light shows, including ones that are synchronized with sound.

The PX340+ has a screen and buttons, so user can read the basic operating parameters. Thanks to the additional *BUS1* and *BUS2* buses, the device can be extended with additional PX723 Keyboard 8, PX734 Light & Movement Sensor and PX778 Extension module 8ch modules. Two independent buses can be connected in series with max. 32 modules each (max. 64 modules in total).

The controller comes with an application for mobile devices (Android™, iOS) which enables simple control.

The controller can be used to create up to 8 users with different access rights. There is an option to remotely log on to the controller from the external network.

Technical drawing

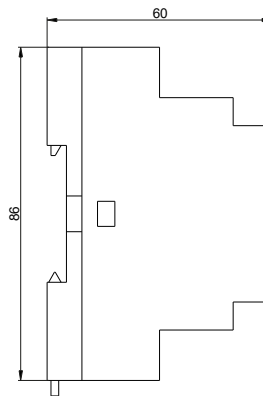
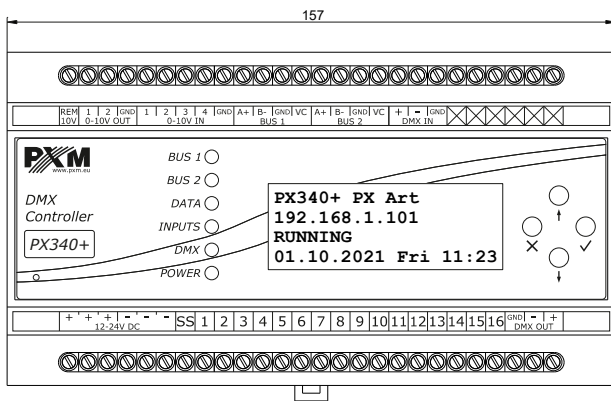

Connection diagram

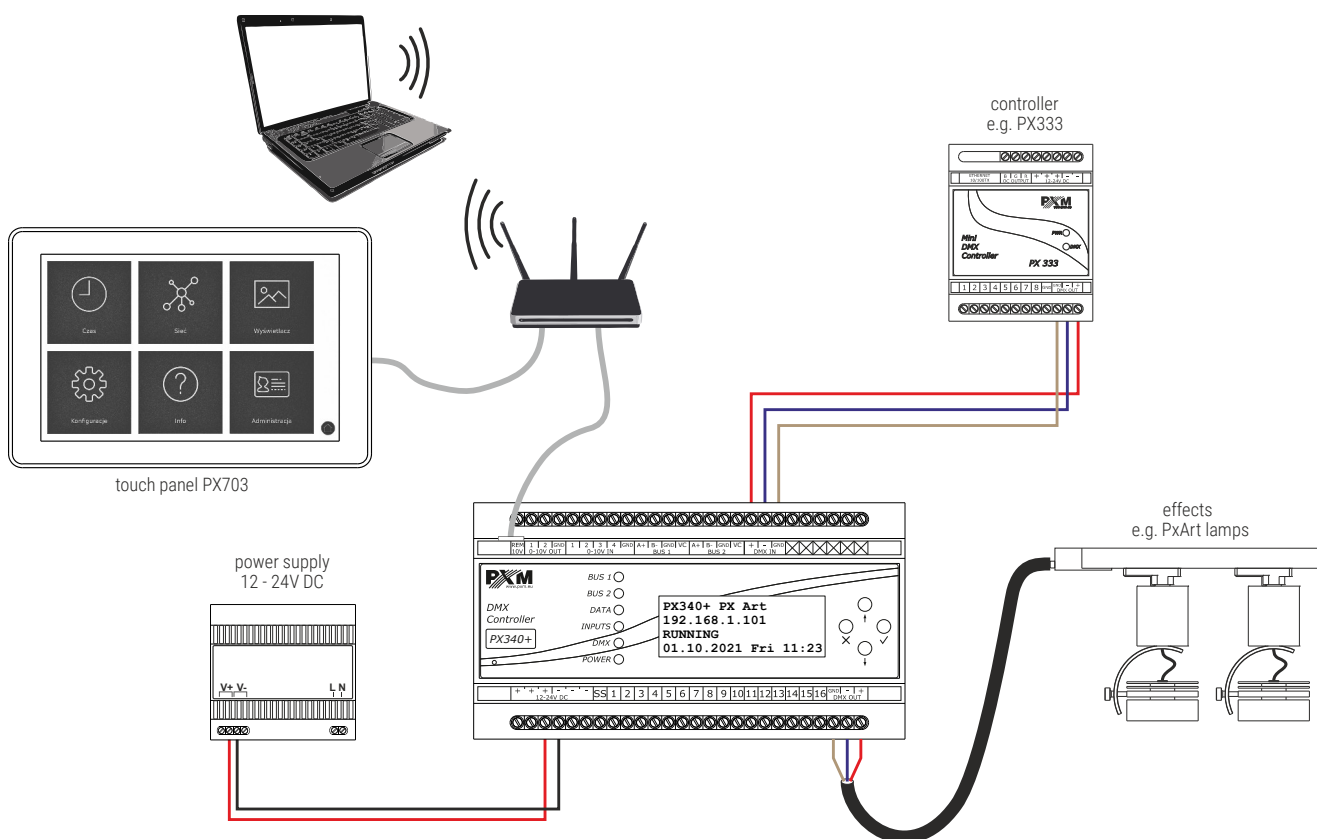

Technical data

type	PX340+
power supply	12 – 24V DC
max. power consumption	7W (without external devices connected to the <i>BUS1</i> and <i>BUS2</i>)
DMX input	1 (512 channels)
DMX output	1 (512 channels)
control inputs (on / off)	16
analog inputs	4
REM 10V output load	max. 20mA
analog outputs	2
load on analog outputs	max. 10mA / channel
maximum number of external devices	64 (max. 32 for one BUS line)
external touchpanels	max. 16
Ethernet port	1
Real Time Clock (RTC)	yes
Modbus	TCP
scenes and programs steps	251000
number of scenes running simultaneously	max. 200
programs	512 (max. 40 simultaneously)
sequences	128
statuses	256
timers	1024
zones	16
users (including ADMIN)	8
weight	0.3kg
dimensions	width: 157mm (9 DIN rail modules) height: 86mm depth: 60mm